

- 1
- 2
- 3
- 4
- 5
- 6
- 7
- 8
- 9
- 10
- 11
- 12
- 13
- 14
- 15
- 16
- 17
- 18

PIASTRA BASE

- **DVA:** acciaio zincato lucido.
- **DVA-SST:** acciaio INOX AISI 304.

CORPO ANTIVIBRANTE

- Gomma naturale NR, colore nero.
- **DVA:** durezza 40, 55, 70 Shore A ± 5 .
 - **DVA-SST:** durezza 55 Shore A ± 5 .

ESECUZIONI STANDARD

- **DVA.1:** prigionieri filettati acciaio zincato lucido.
- **DVA.1-SST:** prigionieri filettati acciaio INOX AISI 304.
- **DVA.2:** prigioniero filettato e boccola acciaio zincato lucido, foro cieco filettato.
- **DVA.2-SST:** prigioniero filettato e boccola acciaio INOX AISI 304, foro cieco filettato.
- **DVA.3:** boccole acciaio zincato lucido, fori ciechi filettati.
- **DVA.3-SST:** boccole acciaio INOX AISI 304, fori ciechi filettati.

CARATTERISTICHE E APPLICAZIONI

Gli elementi antivibranti sono stati progettati per smorzare le vibrazioni, gli urti o il rumore generati da parti in movimento o masse vibranti non bilanciate di macchine operatrici. Com'è noto le vibrazioni possono provocare:

- cattivo funzionamento e riduzione della vita utile della macchina stessa e/o di quelle ad essa adiacenti;
- danni per la salute dell'uomo;
- rumore.

Diagrammi di carico per ogni singolo codice disponibili a richiesta. Vedi Criteri di scelta (a pag. 1012).

ESECUZIONI SPECIALI A RICHIESTA

Gomma naturale NR, durezza 40, 70 in tolleranza ± 5 Shore A per le esecuzioni con piastra base in acciaio inox AISI 304.

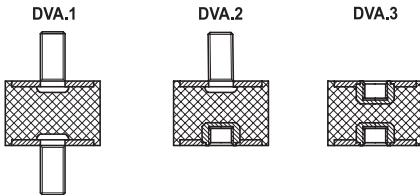

* Completare la descrizione con la durezza desiderata:
40, 55 o 70 in tolleranza ±5 Shore A.

DVA.1 - 8 - 8 - M3 - 6 - 55
 D L d I Shore A

DVA.1

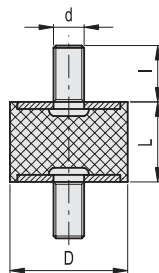

Descrizione	D	L	d	I	⚖️	Durezza 40 Shore A				Durezza 55 Shore A				Durezza 70 Shore A			
						Codice	Carico max. [N]	Deflessione max. [mm]	Rigidezza [N/mm]	Codice	Carico max. [N]	Deflessione max. [mm]	Rigidezza [N/mm]	Codice	Carico max. [N]	Deflessione max. [mm]	Rigidezza [N/mm]
DVA.1-8-8-M3-6-*	8	8	M3	6	1	413801	50	2	25	411101	85	2	43	416501	150	2	75
DVA.1-8-13-M3-6-*	8	13	M3	6	2	413803	62	3	19	411003	94	3	29	416503	133	3	41
DVA.1-10-10-M4-10-*	10	10	M4	10	2	413811	75	3	30	411121	100	3	40	416511	200	3	80
DVA.1-10-15-M4-10-*	10	15	M4	10	3	413821	65	4	17	411131	100	4	26	416521	150	4	40
DVA.1-10-20-M4-10-*	10	20	M4	10	3	413823	59	5	12	411133	93	5	19	416523	96	5	19
DVA.1-15-8-M4-10-*	15	8	M4	10	5	413831	437	2	219	411141	537	2	269	416531	1325	2	663
DVA.1-15-10-M4-10-*	15	10	M4	10	6	413841	210	3	84	411151	325	3	130	416541	717	3	287
DVA.1-15-15-M4-10-*	15	15	M4	10	7	413851	155	4	41	411161	280	4	75	416551	513	4	137
DVA.1-15-20-M4-10-*	15	20	M4	10	8	413861	151	5	30	411171	234	5	47	416561	468	5	94
DVA.1-15-25-M4-10-*	15	25	M4	10	9	413863	133	6	21	411019	234	6	37	411173	498	6	80
DVA.1-20-15-M6-18-*	20	15	M6	18	18	413871	322	4	86	411181	479	4	128	416571	1044	4	278
DVA.1-20-20-M6-18-*	20	20	M6	18	25	413881	220	5	44	411201	430	5	86	416581	995	5	199
DVA.1-20-25-M6-18-*	20	25	M6	18	20	413891	264	6	42	411211	433	6	69	416591	1010	6	162
DVA.1-20-30-M6-18-*	20	30	M6	18	23	413893	214	8	29	411213	417	8	56	416593	978	8	130
DVA.1-25-15-M6-18-*	25	15	M6	18	28	413901	860	4	229	411221	1068	4	285	416601	2690	4	717
DVA.1-25-20-M6-18-*	25	20	M6	18	31	413911	391	5	78	411241	620	5	124	416611	1533	5	307
DVA.1-25-25-M6-18-*	25	25	M6	18	35	413921	441	6	71	411261	529	6	85	416621	1374	6	220
DVA.1-25-30-M6-18-*	25	30	M6	18	38	413931	432	8	58	411271	524	8	70	416631	1208	8	161
DVA.1-30-15-M8-20-*	30	15	M8	20	45	413941	986	4	263	411281	2100	1.5	1400	416641	2700	1.5	1800
DVA.1-30-20-M8-20-*	30	20	M8	20	50	413951	770	5	154	411301	1067	5	213	416651	2260	5	452
DVA.1-30-30-M8-20-*	30	30	M8	20	57	413961	500	8	67	411321	1055	8	141	416661	1960	8	261
DVA.1-30-40-M8-20-*	30	40	M8	20	65	413963	649	10	65	411323	932	10	93	416663	2000	10	200
DVA.1-40-20-M8-23-*	40	20	M8	23	80	413971	1800	5	360	411331	2430	5	486	416671	4450	5	890
DVA.1-40-30-M8-23-*	40	30	M8	23	95	413981	1137	8	152	411341	1574	8	210	416681	3420	8	456
DVA.1-40-40-M8-23-*	40	40	M8	23	100	413991	1056	10	106	411361	1397	10	140	416691	3190	10	319
DVA.1-50-20-M10-28-*	50	20	M10	28	130	414001	3030	5	606	411381	4100	5	820	416701	9240	5	1848
DVA.1-50-30-M10-28-*	50	30	M10	28	184	414011	2010	8	268	411401	3300	8	440	416711	5450	8	727
DVA.1-50-40-M10-28-*	50	40	M10	28	170	414021	1477	10	148	411421	2130	10	213	416721	4940	10	494
DVA.1-50-45-M10-28-*	50	45	M10	28	180	414031	1368	11	122	411441	2046	11	182	416731	2580	11	229
DVA.1-50-50-M10-28-*	50	50	M10	28	195	414041	1500	13	120	411446	2188	13	175	416741	4750	13	380
DVA.1-60-30-M10-28-*	60	30	M10	28	211	414051	3020	8	403	411451	4170	8	556	416751	9130	8	1217
DVA.1-60-40-M10-28-*	60	40	M10	28	236	414061	2520	10	252	411456	3610	10	361	416761	6950	10	695
DVA.1-60-50-M10-28-*	60	50	M10	28	261	414063	2458	13	197	411457	3410	13	273	416763	6570	13	526
DVA.1-70-30-M10-28-*	70	30	M10	28	297	414070	6370	8	849	411460	8570	8	1143	416770	24010	8	3382
DVA.1-70-45-M10-28-*	70	45	M10	28	380	414071	3810	11	339	411461	7130	11	634	416771	13210	11	1174
DVA.1-75-25-M12-37-*	75	25	M12	37	345	414081	11000	6	1760	411471	12970	6	2075	416781	25000	6	4000
DVA.1-75-40-M12-37-*	75	40	M12	37	410	414091	4910	10	491	411481	6970	10	697	416791	15380	10	1538
DVA.1-75-55-M12-37-*	75	55	M12	37	515	414101	3470	14	252	411501	7510	14	546	416801	11240	14	817
DVA.1-100-40-M16-41-*	100	40	M16	41	765	414111	13990	10	1399	411521	20000	10	2000	416811	29000	10	2900
DVA.1-100-55-M16-41-*	100	55	M16	41	905	414121	7320	14	532	411541	13080	14	951	416821	24260	14	1764
DVA.1-100-60-M16-41-*	100	60	M16	41	950	414131	7000	15	467	411561	11290	15	753	416831	28500	15	1900
DVA.1-100-75-M16-41-*	100	75	M16	41	1090	414141	7790	19	415	411581	9640	19	514	416841	22350	19	1192
DVA.1-125-55-M16-41-*	125	55	M16	41	1320	414161	17270	14	1256	411601	19260	14	1401	416901	23610	8	3008
DVA.1-125-75-M16-41-*	125	75	M16	41	1625	414163	12235	19	653	411603	19440	19	1037	416903	21789	19	1162



Elementi antivibranti

- 1
- 2
- 3
- 4
- 5
- 6
- 7
- 8
- 9
- 10
- 11
- 12
- 13
- 14
- 15
- 16
- 17
- 18

DVA.1-SST

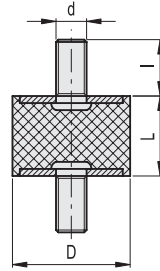

DVA.1 - 8 - 8 - SST - M3 - 6 - 55
 D L Stainless steel d l Shore A

Descrizione	D	L	d	l	⚖	Durezza 40 Shore A			Durezza 55 Shore A			Durezza 70 Shore A					
						Codice	Carico max. [N]	Deflessione max. [mm]	Rigidezza [N/mm]	Codice	Carico max. [N]	Deflessione max. [mm]	Rigidezza [N/mm]	Codice	Carico max. [N]	Deflessione max. [mm]	Rigidezza [N/mm]
DVA.1-8-8-SST-M3-6-55	8	8	M3	6	1		50	2	25	410001	85	2	43		150	2	75
DVA.1-8-13-SST-M3-6-55	8	13	M3	6	2		62	3	19	410003	94	3	29		133	3	41
DVA.1-10-10-SST-M4-10-55	10	10	M4	10	2		75	3	30	410005	100	3	40		200	3	80
DVA.1-10-15-SST-M4-10-55	10	15	M4	10	3		65	4	17	410007	100	4	26		150	4	40
DVA.1-10-20-SST-M4-10-55	10	20	M4	10	3		59	5	12	410009	93	5	19		96	5	19
DVA.1-15-8-SST-M4-10-55	15	8	M4	10	5		437	2	219	410011	537	2	269		1325	2	663
DVA.1-15-10-SST-M4-10-55	15	10	M4	10	6		210	3	84	410013	325	3	130		717	3	287
DVA.1-15-15-SST-M4-10-55	15	15	M4	10	7		155	4	41	410015	280	4	75		513	4	137
DVA.1-15-20-SST-M4-10-55	15	20	M4	10	8		151	5	30	410017	234	5	47		468	5	94
DVA.1-15-25-SST-M4-10-55	15	25	M4	10	9		133	6	21	410019	234	6	37		498	6	80
DVA.1-20-15-SST-M6-18-55	20	15	M6	18	18		322	4	86	410021	479	4	128		1044	4	278
DVA.1-20-20-SST-M6-18-55	20	20	M6	18	20		220	5	44	410023	430	5	86		995	5	199
DVA.1-20-25-SST-M6-18-55	20	25	M6	18	25		264	6	42	410025	433	6	69		1010	6	162
DVA.1-20-30-SST-M6-18-55	20	30	M6	18	23		214	8	29	410027	417	8	56		978	8	130
DVA.1-25-15-SST-M6-18-55	25	15	M6	18	28		860	4	229	410031	1068	4	285		2690	4	717
DVA.1-25-20-SST-M6-18-55	25	20	M6	18	31		391	5	78	410033	620	5	124		1533	5	307
DVA.1-25-25-SST-M6-18-55	25	25	M6	18	35		441	6	71	410035	529	6	85		1374	6	220
DVA.1-25-30-SST-M6-18-55	25	30	M6	18	38		432	8	58	410037	524	8	70		1208	8	161
DVA.1-30-15-SST-M8-20-55	30	15	M8	20	45		986	4	263	410041	2080	4	555		3300	4	880
DVA.1-30-20-SST-M8-20-55	30	20	M8	20	50		770	5	154	410043	1067	5	213		2260	5	452
DVA.1-30-30-SST-M8-20-55	30	30	M8	20	57		500	8	67	410045	1055	8	141		1960	8	261
DVA.1-30-40-SST-M8-20-55	30	40	M8	20	65		649	10	65	410047	932	10	93		2000	10	200
DVA.1-40-20-SST-M8-23-55	40	20	M8	23	80		1800	5	360	410051	2430	5	486		4450	5	890
DVA.1-40-30-SST-M8-23-55	40	30	M8	23	95		1137	8	152	410053	1574	8	210		3420	8	456
DVA.1-40-40-SST-M8-23-55	40	40	M8	23	100		1056	10	106	410055	1397	10	140		3190	10	319
DVA.1-50-20-SST-M10-28-55	50	20	M10	28	130		3030	5	606	410061	4100	5	820		9240	5	1848
DVA.1-50-30-SST-M10-28-55	50	30	M10	28	184		2010	8	268	410063	3300	8	440		5450	8	727
DVA.1-50-40-SST-M10-28-55	50	40	M10	28	170		1477	10	148	410065	2130	10	213		4940	10	494
DVA.1-50-45-SST-M10-28-55	50	45	M10	28	180		1368	11	122	410067	2046	11	182		2580	11	229
DVA.1-50-50-SST-M10-28-55	50	50	M10	28	195		1500	13	120	410069	2188	13	175		4750	13	380
DVA.1-60-30-SST-M10-28-55	60	30	M10	28	211		3020	8	403	410071	4170	8	556		9130	8	1217
DVA.1-60-40-SST-M10-28-55	60	40	M10	28	236		2520	10	252	410073	3610	10	361		6950	10	695
DVA.1-60-50-SST-M10-28-55	60	50	M10	28	261		2458	13	197	410075	3410	13	273		6570	13	526
DVA.1-70-30-SST-M10-28-55	70	30	M10	28	297		6370	8	849	410076	8570	8	1143		24010	8	3382
DVA.1-70-45-SST-M10-28-55	70	45	M10	28	380		3810	11	339	410077	7130	11	634		13210	11	1174
DVA.1-75-25-SST-M12-37-55	75	25	M12	37	345		11000	6	1760	410081	12970	6	2075		25000	6	4000
DVA.1-75-40-SST-M12-37-55	75	40	M12	37	410		4910	10	491	410083	6970	10	697		15380	10	1538
DVA.1-75-55-SST-M12-37-55	75	55	M12	37	515		3470	14	252	410085	7510	14	546		11240	14	817
DVA.1-100-40-SST-M16-41-55	100	40	M16	41	765		13990	10	1399	410091	20000	10	2000		29000	10	2900
DVA.1-100-55-SST-M16-41-55	100	55	M16	41	905		7320	14	532	410093	13080	14	951		24260	14	1764
DVA.1-100-60-SST-M16-41-55	100	60	M16	41	950		7000	15	467	410095	11290	15	753		28500	15	1900
DVA.1-100-75-SST-M16-41-55	100	75	M16	41	1090		7790	19	415	410097	9640	19	514		22350	19	1192
DVA.1-125-55-SST-M16-41-55	125	55	M16	41	1320		17270	14	1256	410098	19260	14	1401		23610	14	3008
DVA.1-125-75-SST-M16-41-55	125	75	M16	41	1600		12235	19	653	410099	19440	19	1037		21789	19	1162

A RICHIESTA

A RICHIESTA

Elementi antivibranti

* Completare la descrizione con la durezza desiderata:
40, 55 o 70 in tolleranza ±5 Shore A.

DVA.2 - 8 - 8 - M3 - 6 - 55
 D L d l Shore A

DVA.2

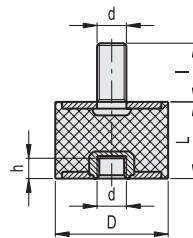

Descrizione	D	L	d	l	h	⚖️	Durezza 40 Shore A				Durezza 55 Shore A				Durezza 70 Shore A			
							Codice	Carico max. [N]	Deflessione max. [mm]	Rigidezza [N/mm]	Codice	Carico max. [N]	Deflessione max. v [mm]	Rigidezza [N/mm]	Codice	Carico max. [N]	Deflessione max. [mm]	Rigidezza [N/mm]
DVA.2-8-8-M3-6-*	8	8	M3	6	3	1	414301	50	2	25	411701	85	2	43	417001	150	2	75
DVA.2-8-13-M3-6-*	8	13	M3	6	3	2	414303	38	3	12	411703	70	3	21	417003	145	3	45
DVA.2-10-10-M4-10-*	10	10	M4	10	4	2	414311	75	3	30	411721	100	3	40	417011	200	3	80
DVA.2-10-15-M4-10-*	10	15	M4	10	4	3	414321	65	4	17	411731	100	4	27	417021	150	4	40
DVA.2-10-20-M4-10-*	10	20	M4	10	4	3	414323	59	5	12	411733	93	5	19	417023	132	5	26
DVA.2-15-10-M4-10-*	15	10	M4	10	4	5	414331	210	2	105	411741	325	2	163	417031	717	2	359
DVA.2-15-15-M4-10-*	15	15	M4	10	4	6	414341	155	4	41	411761	280	4	75	417041	513	4	137
DVA.2-15-20-M4-10-*	15	20	M4	10	4	7	414351	151	5	30	411771	234	5	47	417051	468	5	94
DVA.2-15-25-M4-10-*	15	25	M4	10	4	8	414353	133	6	21	411773	234	6	37	417053	505	6	81
DVA.2-20-15-M6-18-*	20	15	M6	18	6	15	414361	322	4	86	411781	479	4	128	417061	1044	4	278
DVA.2-20-20-M6-18-*	20	20	M6	18	6	17	414371	220	5	44	411801	430	5	86	417071	995	5	199
DVA.2-20-25-M6-18-*	20	25	M6	18	6	18	414381	264	6	42	411811	433	6	69	417081	1010	6	162
DVA.2-20-30-M6-18-*	20	30	M6	18	6	21	414383	261	8	35	411813	417	8	56	417083	1213	8	162
DVA.2-25-15-M6-18-*	25	15	M6	18	6	26	414391	860	4	229	411821	1068	4	285	417091	2690	4	717
DVA.2-25-20-M6-18-*	25	20	M6	18	6	28	414401	391	5	78	411841	620	5	124	417101	1533	5	307
DVA.2-25-30-M6-18-*	25	30	M6	18	6	36	414411	432	8	58	411851	524	8	70	417111	1208	8	161
DVA.2-30-15-M8-20-*	30	15	M8	20	8	41	414421	986	4	263	411861	2100	1.5	1400	417121	2700	1.5	1800
DVA.2-30-20-M8-20-*	30	20	M8	20	8	43	414431	1300	5	260	411881	3070	5	614	417131	2000	2.75	727
DVA.2-30-30-M8-20-*	30	30	M8	20	8	50	414441	500	8	67	411901	1055	8	141	417141	1960	8	261
DVA.2-30-40-M8-20-*	30	40	M8	20	8	60	414443	591	10	59	411903	932	10	93	417143	2000	10	200
DVA.2-40-20-M8-23-*	40	20	M8	23	8	73	414451	3490	5	698	411911	2200	3.5	628	417151	10160	5	2032
DVA.2-40-30-M8-23-*	40	30	M8	23	8	85	414461	1137	8	152	411921	1574	8	210	417161	3420	8	456
DVA.2-40-40-M8-23-*	40	40	M8	23	8	98	414471	1056	10	106	411941	1397	10	140	417171	3190	10	319
DVA.2-50-20-M10-28-*	50	20	M10	28	10	115	414481	11610	5	2322	411961	14030	5	2806	417181	22540	5	4508
DVA.2-50-30-M10-28-*	50	30	M10	28	10	135	414491	2010	8	268	411981	3300	8	440	417191	5450	8	727
DVA.2-50-40-M10-28-*	50	40	M10	28	10	160	414501	1477	10	148	412001	2130	10	213	417201	4940	10	494
DVA.2-50-45-M10-28-*	50	45	M10	28	10	170	414511	1368	11	122	412021	2046	11	182	417211	2580	11	229
DVA.2-50-50-M10-28-*	50	50	M10	28	10	185	414521	1500	13	120	412026	2188	13	175	417221	4750	13	380
DVA.2-60-30-M10-28-*	60	30	M10	28	10	199	414531	3020	8	403	412031	4170	8	556	417231	9130	8	1217
DVA.2-60-40-M10-28-*	60	40	M10	28	10	220	414541	2520	10	252	412036	3610	10	361	417241	6950	10	695
DVA.2-60-50-M10-28-*	60	50	M10	28	10	245	414543	2650	13	212	412039	3410	13	273	417243	6570	13	526
DVA.2-70-30-M10-28-*	70	30	M10	28	10	329	414550	5940	8	792	412040	8570	8	1143	417250	24010	7	3382
DVA.2-70-45-M10-28-*	70	45	M10	28	10	372	414551	3810	11	339	412041	7130	11	634	417251	13210	11	1174
DVA.2-75-25-M12-37-*	75	25	M12	37	12	321	414561	6150	4	1537	412051	10000	3	3333	417261	15900	3	5300
DVA.2-75-40-M12-37-*	75	40	M12	37	12	385	414571	4910	10	491	412061	6970	10	697	417271	14800	8	1850
DVA.2-75-55-M12-37-*	75	55	M12	37	12	450	414581	3470	14	252	412081	7510	14	546	417281	11240	14	817
DVA.2-100-40-M16-41-*	100	40	M16	41	16	740	414591	13990	10	1399	412101	20000	10	2000	417291	29000	10	2900
DVA.2-100-55-M16-41-*	100	55	M16	41	16	850	414601	7320	14	532	412121	13080	14	951	417301	24260	14	1764
DVA.2-100-60-M16-41-*	100	60	M16	41	16	865	414611	7000	15	467	412141	11290	15	753	417311	28500	15	1900
DVA.2-100-75-M16-41-*	100	75	M16	41	16	980	414621	7790	19	415	412161	9640	19	514	417321	22350	19	1192
DVA.2-125-55-M16-41-*	125	55	M16	41	16	1320	414651	17600	14	1280	412181	19260	14	1401	417351	23610	8	3008
DVA.2-125-75-M16-41-*	125	75	M16	41	16	1600	414661	12760	19	681	412191	19440	19	1037	417361	24205	19	1291



Elementi antivibranti



DVA.2-SST

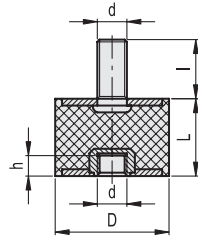

DVA.2 - 8 - 8 - SST - M3 - 6 - 55
 D L Stainless steel d l Shore A



Descrizione	D	L	d	l	h	⚖	Durezza 40 Shore A			Durezza 55 Shore A			Durezza 70 Shore A					
							Codice	Carico max. [N]	Deflessione max. [mm]	Rigidità [N/mm]	Codice	Carico max. [N]	Deflessione max. [mm]	Rigidità [N/mm]	Codice	Carico max. [N]	Deflessione max. [mm]	Rigidità [N/mm]
DVA.2-8-8-SST-M3-6-55	8	8	M3	6	3	1		50	2	25	410101	85	2	43		150	2	75
DVA.2-8-13-SST-M3-6-55	8	13	M3	6	3	2		38	3	12	410103	70	3	21		145	3	45
DVA.2-10-10-SST-M4-10-55	10	10	M4	10	4	2		75	3	30	410105	100	3	40		200	3	80
DVA.2-10-15-SST-M4-10-55	10	15	M4	10	4	3		65	4	17	410107	100	4	27		150	4	40
DVA.2-10-20-SST-M4-10-55	10	20	M4	10	4	3		59	5	12	410109	93	5	19		132	5	26
DVA.2-15-10-SST-M4-10-55	15	10	M4	10	4	5		210	2	105	410113	325	2	163		717	2	359
DVA.2-15-15-SST-M4-10-55	15	15	M4	10	4	6		155	4	41	410115	280	4	75		513	4	137
DVA.2-15-20-SST-M4-10-55	15	20	M4	10	4	7		151	5	30	410117	234	5	47		468	5	94
DVA.2-15-25-SST-M4-10-55	15	25	M4	10	4	8		133	6	21	410119	234	6	37		505	6	81
DVA.2-20-15-SST-M6-18-55	20	15	M6	18	6	15		322	4	86	410121	479	4	128		1044	4	278
DVA.2-20-20-SST-M6-18-55	20	20	M6	18	6	17		220	5	44	410123	430	5	86		995	5	199
DVA.2-20-25-SST-M6-18-55	20	25	M6	18	6	18		264	6	42	410125	433	6	69		1010	6	162
DVA.2-20-30-SST-M6-18-55	20	30	M6	18	6	21		261	8	35	410127	417	8	56		1213	8	162
DVA.2-25-15-SST-M6-18-55	25	15	M6	18	6	26		860	4	229	410131	1068	4	285		2690	4	717
DVA.2-25-20-SST-M6-18-55	25	20	M6	18	6	28		391	5	78	410133	620	5	124		1533	5	307
DVA.2-25-30-SST-M6-18-55	25	30	M6	18	6	36		432	8	58	410137	524	8	70		1208	8	161
DVA.2-30-15-SST-M8-20-55	30	15	M8	20	8	41		986	4	263	410141	2080	4	555		3300	4	880
DVA.2-30-20-SST-M8-20-55	30	20	M8	20	8	43		1300	5	260	410143	3070	5	614		7540	5	1508
DVA.2-30-30-SST-M8-20-55	30	30	M8	20	8	50		591	8	67	410145	1055	8	141		1960	8	261
DVA.2-30-40-SST-M8-20-55	30	40	M8	20	8	60		591	10	59	410147	932	10	93		2000	10	200
DVA.2-40-20-SST-M8-23-55	40	20	M8	23	8	73		3490	5	698	410151	8420	5	1684		10160	5	2032
DVA.2-40-30-SST-M8-23-55	40	30	M8	23	8	85		1137	8	152	410153	1574	8	210		3420	8	456
DVA.2-40-40-SST-M8-23-55	40	40	M8	23	8	98		1056	10	106	410155	1397	10	140		3190	10	319
DVA.2-50-20-SST-M10-28-55	50	20	M10	28	10	115		11610	5	2322	410161	14030	5	2806		22540	5	4508
DVA.2-50-30-SST-M10-28-55	50	30	M10	28	10	135		2010	8	268	410163	3300	8	440		5450	8	727
DVA.2-50-40-SST-M10-28-55	50	40	M10	28	10	160		1477	10	148	410165	2130	10	213		4940	10	494
DVA.2-50-45-SST-M10-28-55	50	45	M10	28	10	170		1368	11	122	410167	2046	11	182		2580	11	229
DVA.2-50-50-SST-M10-28-55	50	50	M10	28	10	185		1500	13	120	410169	2188	13	175		4750	13	380
DVA.2-60-30-SST-M10-28-55	60	30	M10	28	10	199		3020	8	403	410171	4170	8	556		9130	8	1217
DVA.2-60-40-SST-M10-28-55	60	40	M10	28	10	220		2520	10	252	410173	3610	10	361		6950	10	695
DVA.2-60-50-SST-M10-28-55	60	50	M10	28	10	245		2650	13	212	410175	3410	13	273		6570	13	526
DVA.2-70-30-SST-M10-28-55	70	30	M10	28	10	329		5940	8	792	410176	8570	8	1143		24010	7	3382
DVA.2-70-45-SST-M10-28-55	70	45	M10	28	10	372		3810	11	339	410177	7130	11	634		13210	11	1174
DVA.2-75-25-SST-M12-37-55	75	25	M12	37	12	321		4600	3	1533	410181	10000	3	3333		15900	3	5300
DVA.2-75-40-SST-M12-37-55	75	40	M12	37	12	385		4910	10	491	410183	6970	10	697		15380	10	1538
DVA.2-75-55-SST-M12-37-55	75	55	M12	37	12	450		3470	14	252	410185	7510	14	546		11240	14	817
DVA.2-100-40-SST-M16-41-55	100	40	M16	41	16	740		13990	10	1399	410191	20000	10	2000		29000	10	2900
DVA.2-100-55-SST-M16-41-55	100	55	M16	41	16	850		7320	14	532	410193	13080	14	951		24260	14	1764
DVA.2-100-60-SST-M16-41-55	100	60	M16	41	16	865		7000	15	467	410195	11290	15	753		28500	15	1900
DVA.2-100-75-SST-M16-41-55	100	75	M16	41	16	980		7790	19	415	410197	9640	19	514		22350	19	1192
DVA.2-125-55-SST-M16-41-55	125	55	M16	41	16	1320		17600	14	1280	410198	19260	14	1401		23610	8	3008
DVA.2-125-75-SST-M16-41-55	125	75	M16	41	16	1600		12760	19	681	410199	19440	19	1037		24205	19	1291

A RICHIESTA

A RICHIESTA

Elementi antivibranti

* Completare la descrizione con la durezza desiderata: 40, 55 o 70 in tolleranza ± 5 Shore A.

DVA.3 - 8 - 8 - M3 - 55
 D L d Shore A

DVA.3

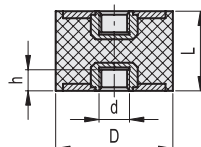

Descrizione	D	L	d	h	△	Durezza 40 Shore A			Durezza 55 Shore A			Durezza 70 Shore A					
						Codice	Carico max. [N]	Deflessione max. [mm]	Rigidità [N/mm]	Codice	Carico max. [N]	Deflessione max. [mm]	Rigidità [N/mm]	Codice	Carico max. [N]	Deflessione max. [mm]	Rigidità [N/mm]
DVA.3-8-8-M3*	8	8	M3	3	1	414801	50	2	25	412301	85	2	43	417501	150	2	75
DVA.3-8-13-M3*	8	13	M3	3	2	414805	41	3	13	412305	74	3	23	417505	152	3	47
DVA.3-10-10-M4*	10	10	M4	4	2	414811	75	3	30	412321	100	3	40	417511	200	3	80
DVA.3-10-15-M4*	10	15	M4	4	3	414821	65	4	17	412326	100	4	27	417521	150	4	40
DVA.3-10-20-M4*	10	20	M4	4	3	414823	54	5	11	412329	108	5	22	417523	201	5	40
DVA.3-15-10-M4*	15	10	M4	4	4	414831	210	2	105	412331	325	2	163	417531	717	2	359
DVA.3-15-15-M4*	15	15	M4	4	6	414841	155	4	41	412341	280	4	75	417541	513	4	137
DVA.3-15-20-M4*	15	20	M4	4	8	414851	151	5	30	412346	234	5	47	417551	468	5	94
DVA.3-20-15-M6*	20	15	M6	6	13	414861	175	2	117	412351	227	2	151	417561	550	2	367
DVA.3-20-20-M6*	20	20	M6	6	16	414871	220	5	44	412361	430	5	86	417571	995	5	199
DVA.3-20-25-M6*	20	25	M6	6	19	414881	264	6	42	412371	433	6	69	417581	1010	6	162
DVA.3-25-20-M6*	25	20	M6	6	26	414891	391	5	78	412381	620	5	124	417591	1533	5	307
DVA.3-25-25-M6*	25	25	M6	6	29	414901	441	6	71	412386	529	6	85	417601	1374	6	220
DVA.3-25-30-M6*	25	30	M6	6	25	414911	432	8	58	412391	524	8	70	417611	1208	8	161
DVA.3-30-20-M8*	30	20	M8	8	39	414921	770	1	1100	412401	1067	1	1524	417621	2260	1	3229
DVA.3-30-30-M8*	30	30	M8	8	45	414931	500	8	67	412421	1055	8	141	417631	1960	8	261
DVA.3-30-40-M8*	30	40	M8	8	53	414941	700	10	70	412431	2100	10	210	417641	2400	10	240
DVA.3-40-20-M8*	40	20	M8	8	64	414950	815	3	255	412440	2650	5	530	417650	6200	2	2818
DVA.3-40-30-M8*	40	30	M8	8	80	414951	1137	8	152	412441	1574	8	210	417651	3420	8	456
DVA.3-40-40-M8*	40	40	M8	8	98	414961	1056	10	106	412461	1397	10	140	417661	3190	10	319
DVA.3-50-30-M10*	50	30	M10	10	125	414971	2010	8	268	412463	3300	8	440	417671	5450	8	727
DVA.3-50-40-M10*	50	40	M10	10	150	414981	1477	10	148	412466	2130	10	213	417681	4940	10	494
DVA.3-50-50-M10*	50	50	M10	10	125	414991	1500	11	133	412469	2188	11	194	417691	4750	11	422
DVA.3-60-30-M10*	60	30	M10	10	189	415001	3020	8	403	412471	4170	8	556	417701	9130	8	1217
DVA.3-60-40-M10*	60	40	M10	10	220	415011	2520	10	252	412476	3610	10	361	417711	6950	10	695
DVA.3-60-50-M10*	60	50	M10	10	310	415013	2930	13	234	412479	3410	13	273	417713	7125	13	570
DVA.3-70-30-M10*	70	30	M10	10	305	415020	3168	4	792	412480	4900	4	1225	417720	7250	3	2417
DVA.3-70-45-M10*	70	45	M10	10	335	415021	3810	11	339	412481	7130	11	624	417721	13210	11	1174
DVA.3-75-30-M12*	75	30	M12	12	320	415030	6880	3	2293	412500	9895	3	3192	417730	25000	5	5000
DVA.3-75-40-M12*	75	40	M12	12	360	415031	4910	10	491	412501	6970	10	697	417731	11880	8	1485
DVA.3-75-55-M12*	75	55	M12	12	445	415041	3470	14	252	412521	7510	14	546	417741	11240	14	817
DVA.3-100-40-M16*	100	40	M16	16	690	415051	13990	10	1399	412541	20000	10	2000	417751	29000	10	2900
DVA.3-100-55-M16*	100	55	M16	16	765	415061	7320	14	532	412551	13080	14	951	417761	24260	14	1764
DVA.3-100-60-M16*	100	60	M16	16	885	415071	7000	15	467	412561	11290	15	753	417771	28500	15	1900
DVA.3-100-75-M16*	100	75	M16	16	965	415081	7790	19	415	412581	9640	19	514	417781	22350	19	1192
DVA.3-125-55-M16*	125	55	M16	16	1320	415091	18240	14	1327	412591	19260	14	1401	417791	25000	8	3185
DVA.3-125-75-M16*	125	75	M16	16	1500	415093	13380	19	714	412593	19440	19	1037	417793	23751	19	1267



Elementi antivibranti

- 1
- 2
- 3
- 4
- 5
- 6
- 7
- 8
- 9
- 10
- 11
- 12
- 13
- 14
- 15
- 16
- 17
- 18

DVA.3 - 8 - 8 - SST - M3 - 55
 D L Stainless steel d Shore A

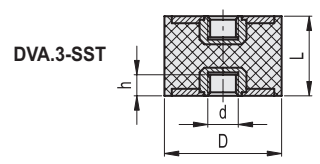

Descrizione	D	L	d	h	⚖	Durezza 40 Shore A				Durezza 55 Shore A				Durezza 70 Shore A			
						Codice	Carico max. [N]	Deflessione max. [mm]	Rigidezza [N/mm]	Codice	Carico max. [N]	Deflessione max. [mm]	Rigidezza [N/mm]	Codice	Carico max. [N]	Deflessione max. [mm]	Rigidezza [N/mm]
DVA.3-8-8-SST-M3-55	8	8	M3	3	1		50	2	25	410201	85	2	43		150	2	75
DVA.3-8-13-SST-M3-55	8	13	M3	3	2		41	3	13	410203	74	3	23		152	3	47
DVA.3-10-10-SST-M4-55	10	10	M4	4	2		75	3	30	410205	100	3	40		200	3	80
DVA.3-10-15-SST-M4-55	10	15	M4	4	3		65	4	17	410207	100	4	27		150	4	40
DVA.3-10-20-SST-M4-55	10	20	M4	4	3		54	5	11	410209	108	5	22		201	5	40
DVA.3-15-10-SST-M4-55	15	10	M4	4	4		210	2	105	410213	325	2	163		717	2	359
DVA.3-15-15-SST-M4-55	15	15	M4	4	6		155	4	41	410215	280	4	75		513	4	137
DVA.3-15-20-SST-M4-55	15	20	M4	4	8		151	5	30	410217	234	5	47		468	5	94
DVA.3-20-15-SST-M6-55	20	15	M6	6	13		175	2	117	410221	227	2	151		550	2	367
DVA.3-20-20-SST-M6-55	20	20	M6	6	16		220	5	44	410223	430	5	86		995	5	199
DVA.3-20-25-SST-M6-55	20	25	M6	6	19		264	6	42	410225	433	6	69		1010	6	162
DVA.3-25-20-SST-M6-55	25	20	M6	6	26		391	5	78	410231	620	5	124		1533	5	307
DVA.3-25-25-SST-M6-55	25	25	M6	6	29		441	6	71	410233	529	6	85		1374	6	220
DVA.3-25-30-SST-M6-55	25	30	M6	6	25		432	8	58	410237	524	8	70		1208	8	161
DVA.3-30-20-SST-M8-55	30	20	M8	8	39		770	1	1100	410241	1067	1	1524		2260	1	3229
DVA.3-30-30-SST-M8-55	30	30	M8	8	45		500	8	67	410243	1055	8	141		1960	8	261
DVA.3-30-40-SST-M8-55	30	40	M8	8	53	A RICHIESTA	700	10	70	410245	2100	10	210	A RICHIESTA	2400	10	240
DVA.3-40-20-SST-M8-55	40	20	M8	8	64		815	3	255	410251	2650	5	530		6200	2	2818
DVA.3-40-30-SST-M8-55	40	30	M8	8	80		1137	8	152	410253	1574	8	210		3420	8	456
DVA.3-40-40-SST-M8-55	40	40	M8	8	98		1056	10	106	410255	1397	10	140		3190	10	319
DVA.3-50-30-SST-M10-55	50	30	M10	10	125		2010	8	268	410263	3300	8	440		5450	8	727
DVA.3-50-40-SST-M10-55	50	40	M10	10	150		1477	10	148	410265	2130	10	213		4940	10	494
DVA.3-50-50-SST-M10-55	50	50	M10	10	125		1500	11	133	410269	2188	11	194		4750	11	422
DVA.3-60-30-SST-M10-55	60	30	M10	10	189		3020	8	403	410271	4170	8	556		9130	8	1217
DVA.3-60-40-SST-M10-55	60	40	M10	10	220		2520	10	252	410273	3610	10	361		6950	10	695
DVA.3-60-50-SST-M10-55	60	50	M10	10	310		2930	13	234	410275	3410	13	273		7125	13	570
DVA.3-70-30-SST-M10-55	70	30	M10	10	305		3168	4	792	410276	4900	4	1225		7250	3	2417
DVA.3-70-45-SST-M10-55	70	45	M10	10	335		3810	11	339	410277	7130	11	624		13210	11	1174
DVA.3-75-30-SST-M12-55	75	30	M12	12	320		6880	3	2293	410281	9895	3	3192		25000	5	5000
DVA.3-75-40-SST-M12-55	75	40	M12	12	360		4910	10	491	410283	6970	10	697		15380	10	1538
DVA.3-75-55-SST-M12-55	75	55	M12	12	445		3470	14	252	410285	7510	14	546		11240	14	817
DVA.3-100-40-SST-M16-55	100	40	M16	16	690		13990	10	1399	410291	20000	10	2000		29000	10	2900
DVA.3-100-55-SST-M16-55	100	55	M16	16	765		7320	14	532	410293	13080	14	951		24260	14	1764
DVA.3-100-60-SST-M16-55	100	60	M16	16	885		7000	15	467	410295	11290	15	753		28500	15	1900
DVA.3-100-75-SST-M16-55	100	75	M16	16	965		7790	19	415	410297	9640	19	514		22350	19	1192
DVA.3-125-55-SST-M16-55	125	55	M16	16	1320		18240	14	1327	410298	19260	14	1401		25000	8	3185
DVA.3-125-75-SST-M16-55	125	75	M16	16	1500		13380	19	714	410299	19440	19	1037		23751	19	1267

Elementi antivibranti